

**Cartridge
Check Valves**

8-30 mm

4600 psi

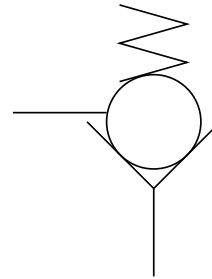
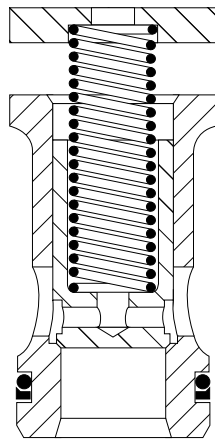

SYMBOL

Specifications	
Valve function	Check valve
Mounting type	Cartridge
Mounting position	Not restricted
Fluid	Mineral oil or HFA / B / C / D
Viscosity	60... 2500 SUS (10... 500 cst)
Fluid Temperature	-13 to 176°F (-25 to 80°C)
Filtration	Contamination class 10, according to NAS 1638 can be realized with filter $\beta_{25} = 75$
Seals	Viton
Available springs	7 psi (.5 bar), 25 psi (1.7 bar), 65 psi (4.5 bar)
Max. operating pressure	4600 psi (315 bar) Caution: System parameters determine retainer type.
Max. flow	See performance curves

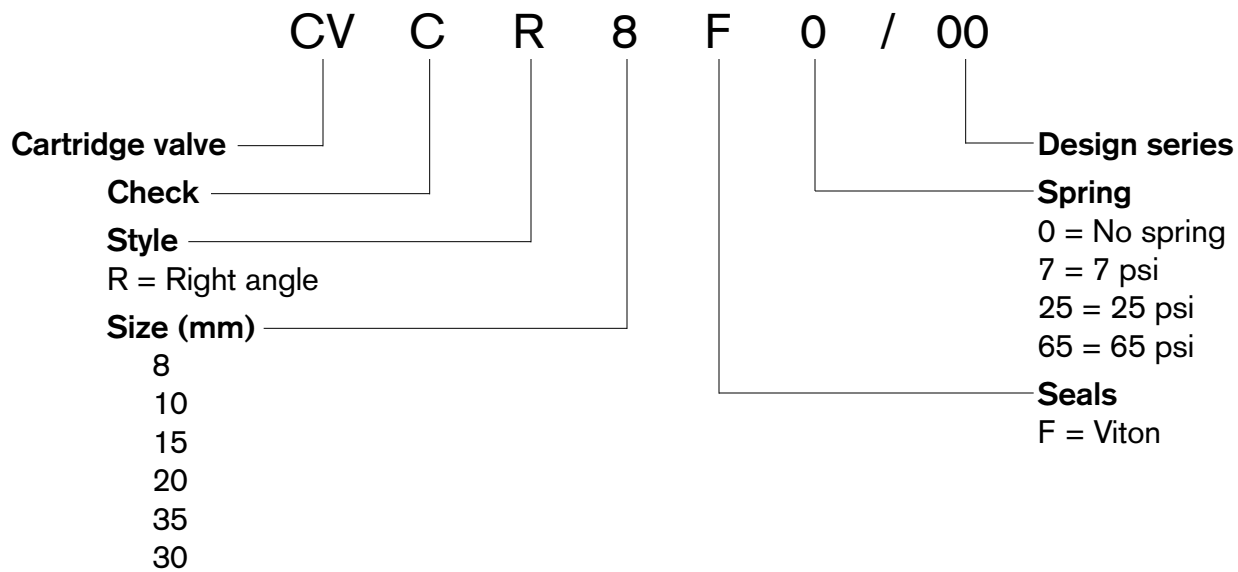

Cartridge size	Assembly code	Assembly P/N
8 mm	CV C R 8 F 0/00	9 811 230 251
	CV C R 8 F 7/00	9 811 230 252
	CV C R 8 F 25/00	9 811 230 253
	CV C R 8 F 65/00	9 811 230 254
10 mm	CV C R 10 F 0/00	9 811 230 255
	CV C R 10 F 7/00	9 811 230 256
	CV C R 10 F 25/00	9 811 230 257
	CV C R 10 F 65/00	9 811 230 258
15 mm	CV C R 15 F 0/00	9 811 230 259
	CV C R 15 F 7/00	9 811 230 260
	CV C R 15 F 25/00	9 811 230 261
	CV C R 15 F 65/00	9 811 230 262
20 mm	CV C R 20 F 0/00	9 811 230 263
	CV C R 20 F 7/00	9 811 230 264
	CV C R 20 F 25/00	9 811 230 265
	CV C R 20 F 65/00	9 811 230 266
25 mm	CV C R 25 F 0/00	9 811 230 267
	CV C R 25 F 7/00	9 811 230 268
	CV C R 25 F 25/00	9 811 230 269
	CV C R 25 F 65/00	9 811 230 270
30 mm	CV C R 30 F 0/00	9 811 230 271
	CV C R 30 F 7/00	9 811 230 272
	CV C R 30 F 25/00	9 811 230 273

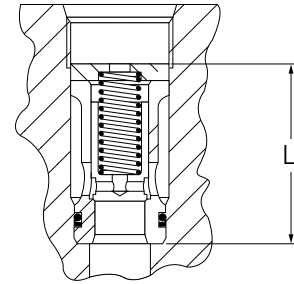
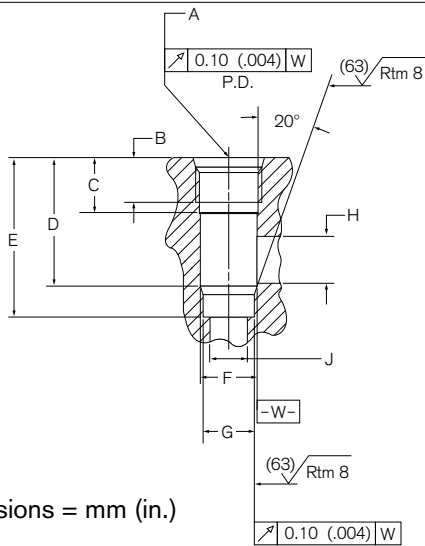

All dimensions = mm (in.)

Notes:

1. Dimensions 'B', 'C', 'D', & 'E' are from surface of spotface for the SAE port specified by 'A'.
2. Unless otherwise specified all surface finishes to be $\sqrt[125]{\text{Rtm 16}}$.

Cartridge Size	8	10	15	20	25	30
S.A.E. Size (UNF - 2B)	3/4 - 16	7/8 - 14	1 1/16 - 12	1 5/16 - 12 3000 psi max	1 5/8 - 12 3000 psi max	1 7/8 - 12 3000 psi max
A	#8 SAE Port except tap drill and full thread depth to depth shown. Spotface for full clean up only. Ref. SAE Spec. SAE J1926	#10 SAE Port except tap drill and full thread depth to depth shown. Spotface for full clean up only. Ref. SAE Spec. SAE J1926	#12 SAE Port except tap drill and full thread depth to depth shown. Spotface for full clean up only. Ref. SAE Spec. SAE J1926	#16 SAE Port except tap drill and full thread depth to depth shown. Spotface for full clean up only. Ref. SAE Spec. SAE J1926	#20 SAE Port except tap drill and full thread depth to depth shown. Spotface for full clean up only. Ref. SAE Spec. SAE J1926	#24 SAE Port except tap drill and full thread depth to depth shown. Spotface for full clean up only. Ref. SAE Spec. SAE J1926
B	11.6 ±0.1 (.455 ±.005)	13.6 ±0.1 (.534 ±.005)	16.0 ±0.1 (.628 ±.005)	16.4 ±0.1 (.644 ±.005)	19.1 ±0.1 (.750 ±.005)	19.1 ±0.1 (.750 ±.005)
C	15.5 ±0.1 (.611 ±.005)	18.1 ±0.1 (.714 ±.005)	21.2 ±0.1 (.836 ±.005)	21.6 ±0.1 (.851 ±.005)	23.0 ±0.1 (.906 ±.005)	23.0 ±0.1 (.906 ±.005)
D	37.7 ±0.1 (1.483 ±.005)	42.2 ±0.1 (1.661 ±.005)	49.0 ±0.1 (1.929 ±.005)	55.5 ±0.1 (2.184 ±.005)	72.5 ±0.1 (2.854 ±.005)	78.5 ±0.1 (3.091 ±.005)
E	47.7 ^{+0.1} / _{-0.0} (1.876 ^{+0.004} / _{-0.000})	52.1 ^{+0.1} / _{-0.0} (2.050 ^{+0.004} / _{-0.000})	61.0 ^{+0.1} / _{-0.0} (2.403 ^{+0.004} / _{-0.000})	70.4 ^{+0.1} / _{-0.0} (2.773 ^{+0.004} / _{-0.000})	89.5 ^{+0.1} / _{-0.0} (3.525 ^{+0.004} / _{-0.000})	98.8 ^{+0.1} / _{-0.0} (3.890 ^{+0.004} / _{-0.000})
Ø F	14.00 ^{+0.03} / _{-0.00} (.552 ^{+0.001} / _{-0.000})	18.00 ^{+0.03} / _{-0.00} (.709 ^{+0.001} / _{-0.000})	24.00 ^{+0.03} / _{-0.00} (.945 ^{+0.001} / _{-0.000})	30.00 ^{+0.03} / _{-0.00} (1.182 ^{+0.001} / _{-0.000})	38.00 ^{+0.04} / _{-0.00} (1.496 ^{+0.001} / _{-0.000})	44.00 ^{+0.04} / _{-0.00} (1.733 ^{+0.001} / _{-0.000})
Ø G	13.00 ^{+0.02} / _{-0.00} (.512 ^{+0.001} / _{-0.000})	17.00 ^{+0.02} / _{-0.00} (.670 ^{+0.001} / _{-0.000})	22.00 ^{+0.02} / _{-0.00} (.866 ^{+0.001} / _{-0.000})	28.00 ^{+0.02} / _{-0.00} (1.102 ^{+0.001} / _{-0.000})	36.00 ^{+0.02} / _{-0.00} (1.418 ^{+0.001} / _{-0.000})	42.00 ^{+0.02} / _{-0.00} (1.654 ^{+0.001} / _{-0.000})
Ø H	18 max. (.70 max.)	19 max. (.74 max.)	24 max. (.94 max.)	30 max. (1.18 max.)	43 max. (1.69 max.)	48 max. (1.88 max.)
Ø J	8 max. (.32 max.)	10 max. (.39 max.)	15 max. (.59 max.)	20 max. (.79 max.)	25 max. (.98 max.)	30 max. (1.18 max.)
L	36.4 max. (1.433 max.)	39.2 max. (1.543 max.)	45.7 max. (1.799 max.)	55.1 max. (2.169 max.)	74.0 max. (2.913 max.)	83.5 max. (3.287 max.)

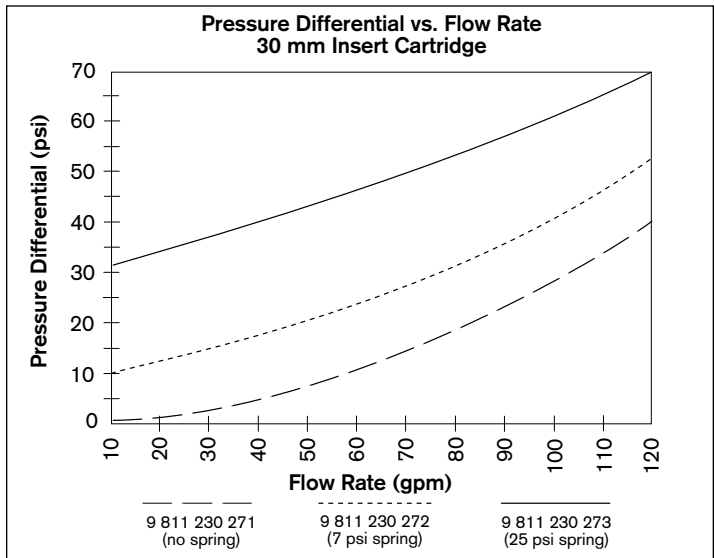
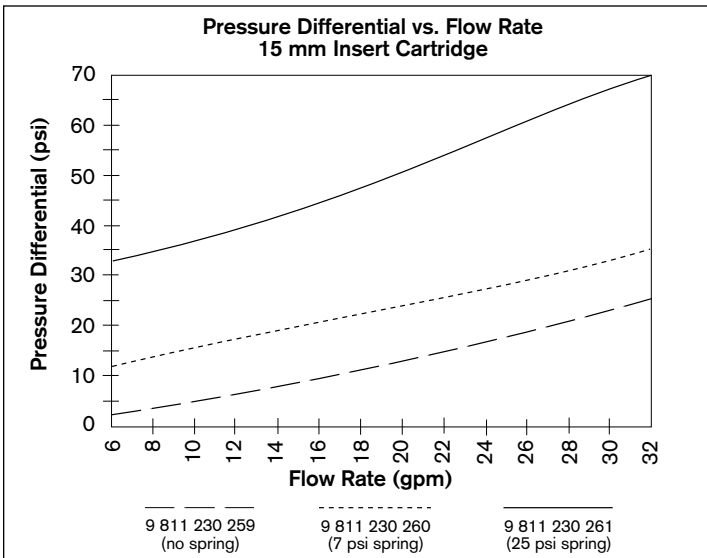
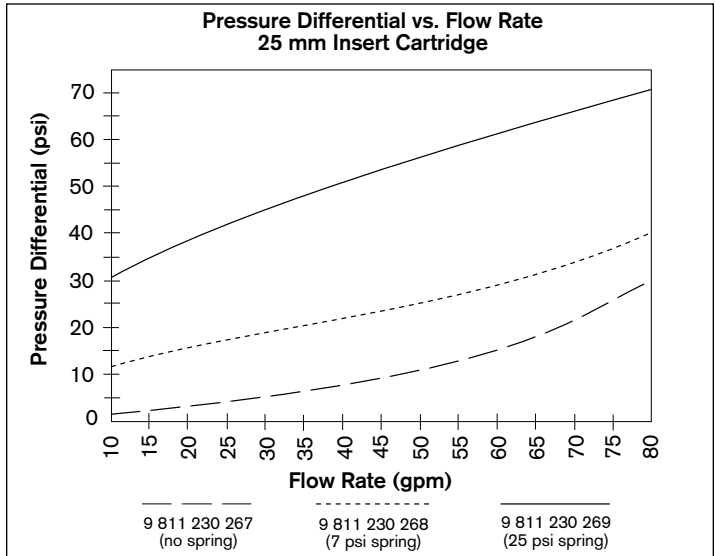
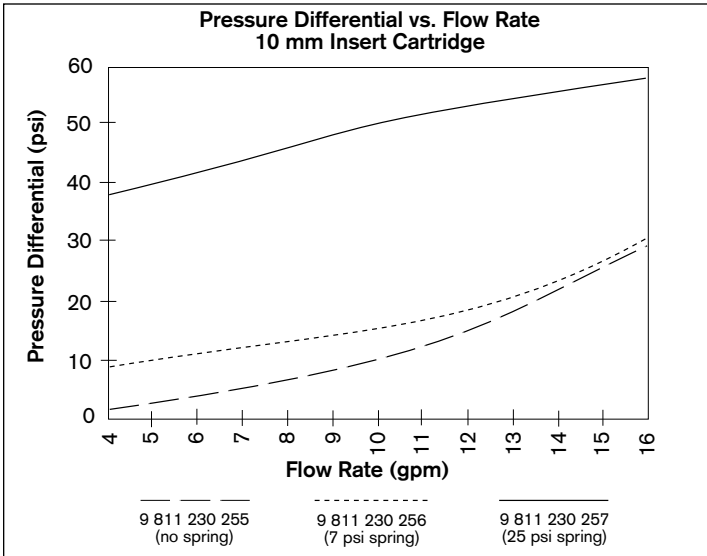
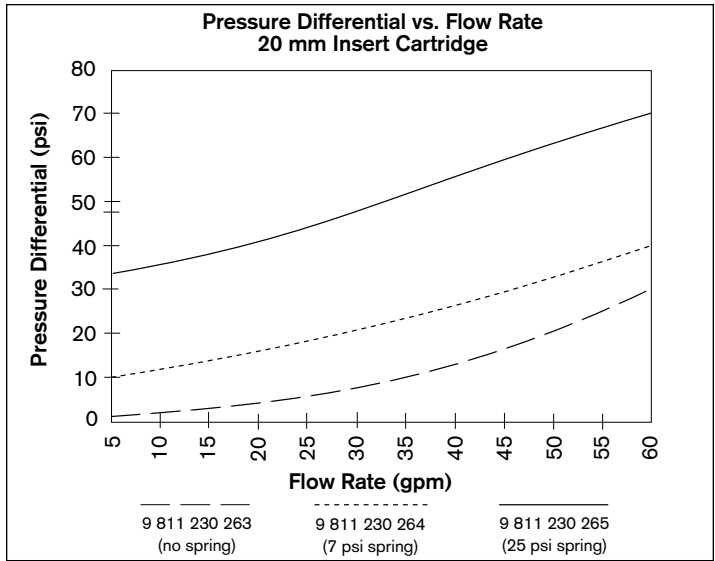
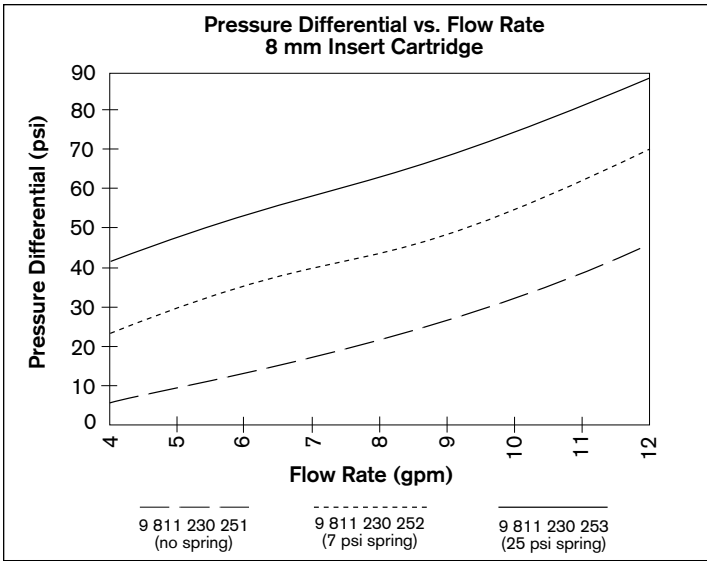

9 535 233 775
HPUS AKY 009/2 US (8.95)

