

REV	DESCRIPTION	DATE	BY	CKD
	RELEASE TO PRODUCTION (CRR0463)	08-12-03	GRJ	D.N.
A	ADDED DRAIN PORT PRESSURE NOTE (CRR0811)	05-28-04	JPC	D.N.

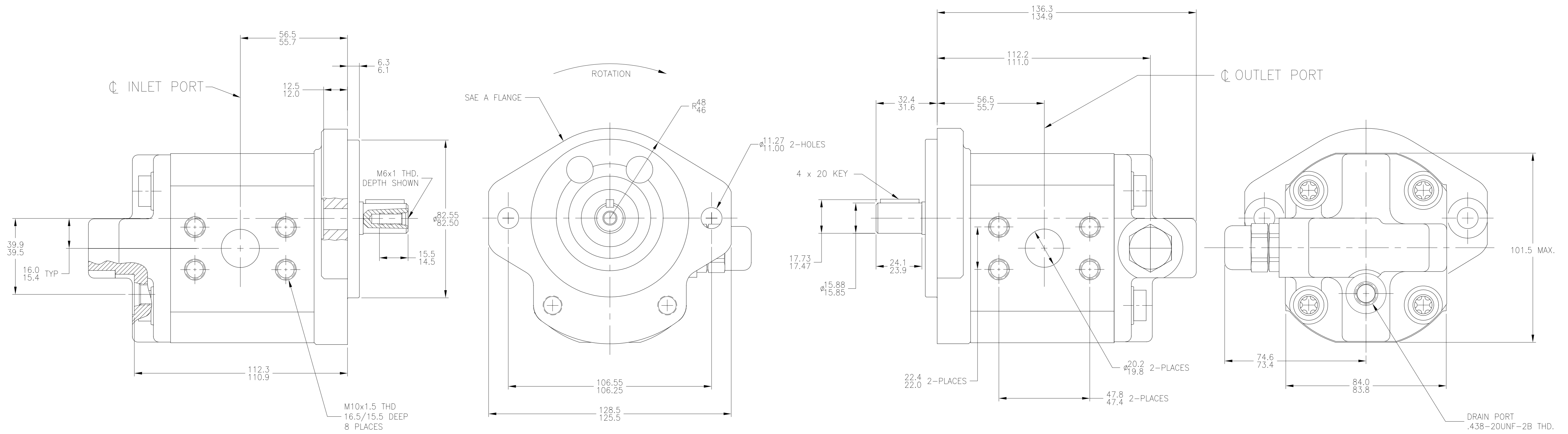

- GENERAL NOTES:
- METRIC LINEAR MEASUREMENTS ARE IN MILLIMETERS
 - ROTATION VIEWING DRIVE END: CLOCKWISE
 - DISPLACEMENT: 22.9 CC/REV
 - OPERATING SPEED: 1000 RPM MIN.
1400 RPM MAX.
 - MOTOR WORKING PRESSURE: 70 BAR (1000 PSI) AT 1400 RPM
 - RELIEF VALVE SETTING: 70.8 +/- 1 BAR AT 1500 RPM, 22°C +/- 2, 75 +/- 10 cST
 - DRAIN PORT PRESSURE NOT TO EXCEED 3 BAR.

DO NOT SCALE UNLESS OTHERWISE SPECIFIED: TOLERANCES PER DIN 7168	DRN GRJ	DATE 03-26-03	DESCRIPTION AZ-M-F-12/022UQR07MDD070-S0028	SCALE FULL
LINEAR DIMENSION TOL.	APPD	DATE	TITLE MOTOR-GEAR, INSTALLATION	DWG. NO. 9511290040
0- 6= ±0.1				SHEET 1 OF 1
6- 30= ±0.2				
30- 120= ±0.3				
120- 400= ±0.5				
400- 1000= ±0.8				
ANGLES = ± 1°				
METRIC	CAD-ORIGINAL	REV. A	MATERIAL	
THIRD ANGLE PROJECTION	Revisions thru CAD Only			

ALL PROPRIETARY RIGHTS IN THE SUBJECT MATTER HEREOF ARE RESERVED, AND NO PERMISSION IS GRANTED TO REPRODUCE THIS PRINT IN WHOLE OR PART, OR TO DISCLOSE ANY OF THE INFORMATION UPON IT TO OTHERS.

Rexroth
Bosch Group
WOOSTER, OHIO 44691