

Application examples

Tolerance ring connections without specific power transmission

With a large number of applications, no particular demands are placed on power transmission. In these cases, the applications in question involve fastening handles, ball knobs, labyrinth rings, female connectors and other machine elements.

When you fasten ball knobs to selector rods using tolerance rings, for example, there is no need for the threads on the rod and in the ball knob that would otherwise be used. In contrast to screw connections, ball knobs with tolerance rings will never come loose.

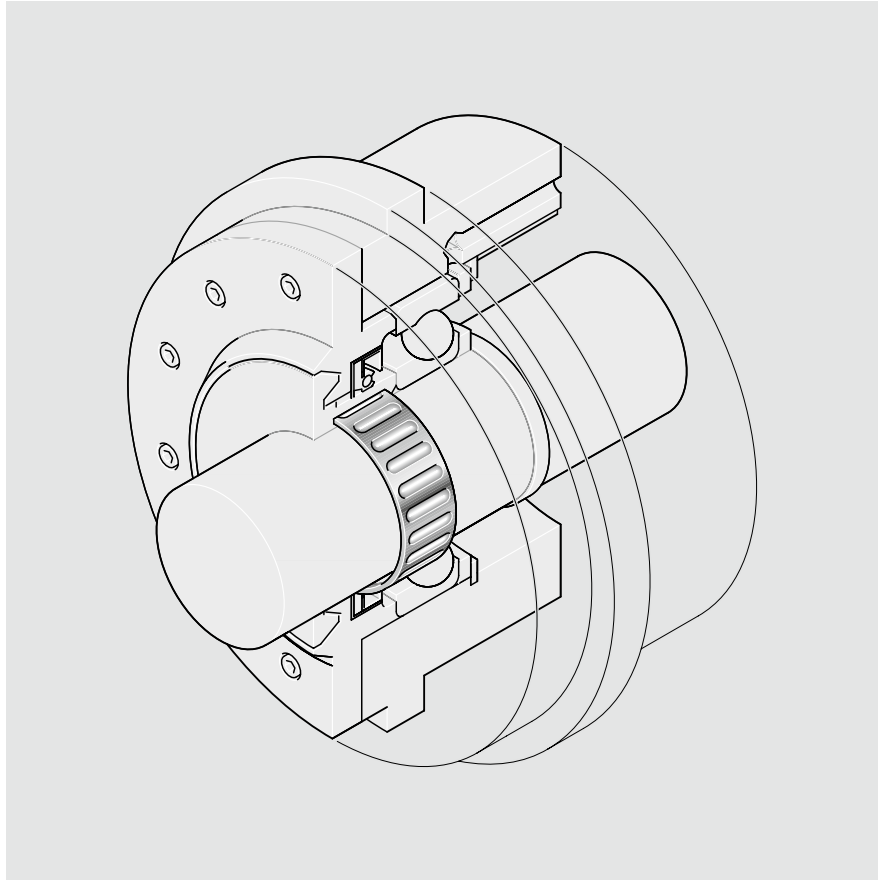

Fastening a labyrinth ring to a shaft using a tolerance ring.

Tolerance ring connections for transmitting torques

In applications like fastening belt pulleys, flywheels or fan blades, for example, specific axial or circumferential forces must be transmitted.

The assembly forces and transferrable torques are highly dependent on the execution and quality of the connecting structure and, in practice, they can differ greatly from the stated values.

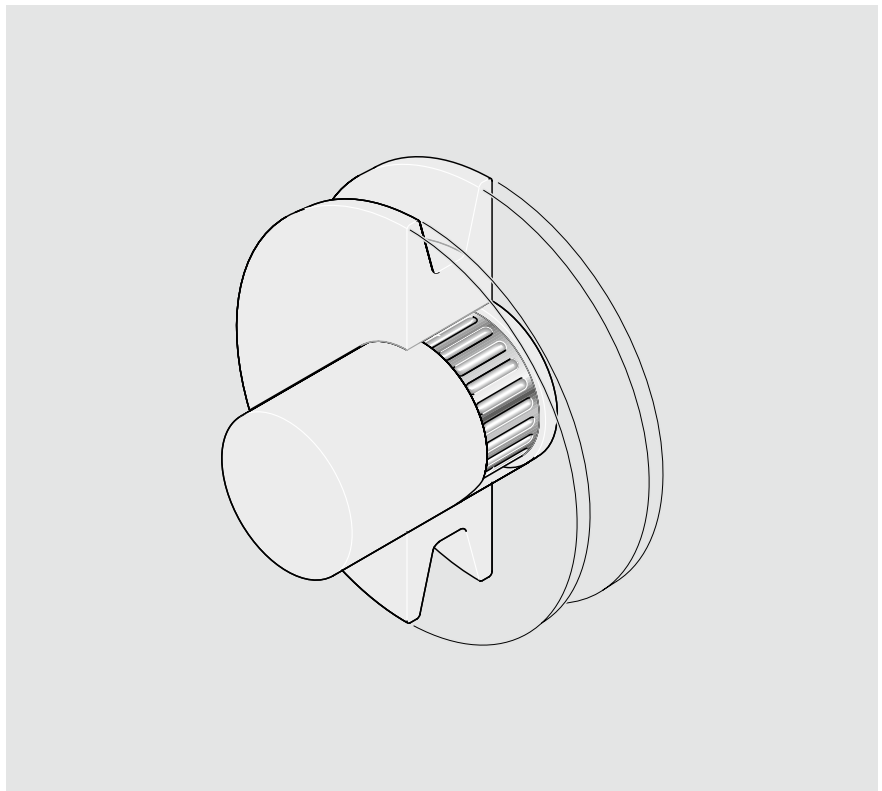

Fastening a V-belt drive to a shaft (instead of a positive-locking connection using a featherkey)

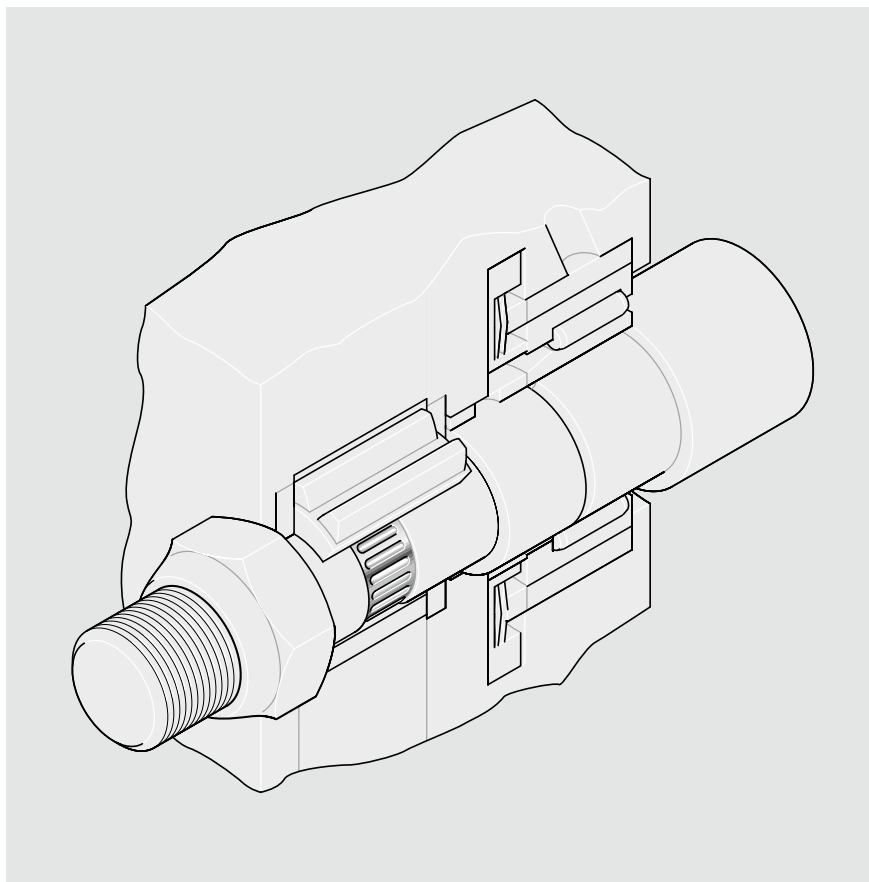

Pinion fastening using a tolerance ring with turbomolecular pumps.

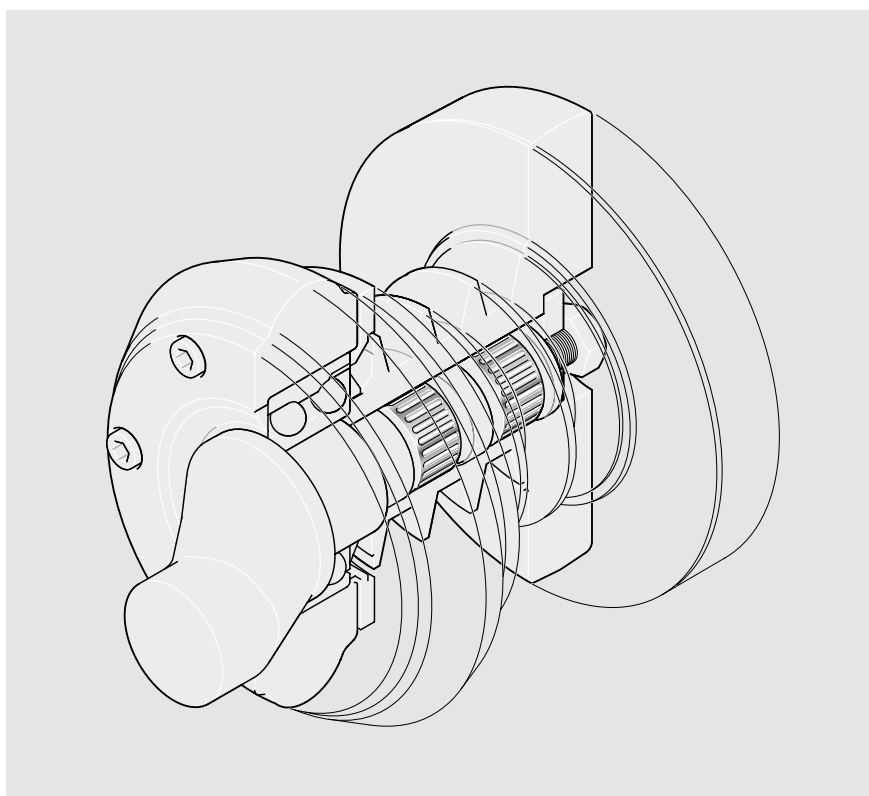

Multiple arrangement of tolerance rings in the drive of a mowing machine.