

Planetary gearbox for mobile applications HYDROTRAC GFT 8150 with TIS (Tire Inflation System)

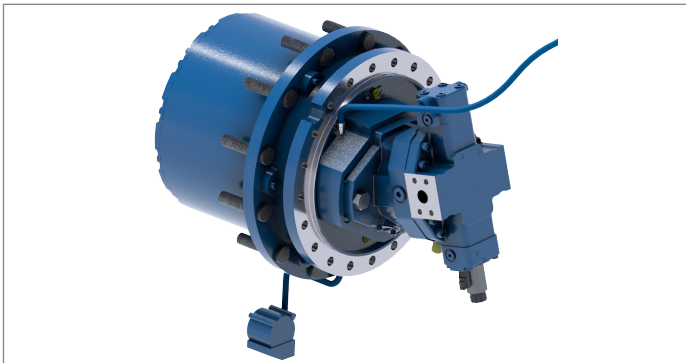

► Sizes to 42000 Nm

Features

- Compact, space-saving two-stage planetary gearbox
- Robust design
- Integrated static and dynamic multiple-disk parking brake
- Assembly of variable plug-in motors different series possible
- For open and closed circuits
- Easy assembly
- Disconnect mechanism (optional)
- Wheel studs (optional)

Features TIS (Tire Inflation System)

- Through the planetary gearbox implemented solution
- No additional vehicle width through external piping
- Increase traction in field operation
- Reduction of ground pressure
- Increase vehicle stability on the road
- Reduction of tire wear
- Reduction of fuel consumption

Contents

Description	2
Technical data	2
Dimensions	2
Application conditions	2
Notes	3
Overview data sheets Gearbox Technology	4

Description

The hydrostatic compact drive series 40 consists of a two-stage planetary gearbox, which - in combination with a hydraulic axial piston motor - builds a space-saving drive unit. The "Tire Inflation System" **TIS** from Rexroth, which is implemented in the planetary gearbox, makes it possible to generate the optimum tire pressure required for field or road travel, without external pressure lines on the vehicle. The complete unit serves mainly as a drive component for wheel-driven harvesters with single-wheel drive e.g. corn harvester, potato harvester, etc.

Application conditions

The planetary gearboxes are designed for use in environmental temperatures between -25°C and +40°C. Environmental factors such as salt water, salt air, sand, dust, pressure, severe shocks, extreme shock loads and environmental temperatures, aggressive media, etc. affect the function. Such influences must be pre-announced in order for a secure gearbox design.

Technical data

Size GFT	Nominal output torque Nm	Ratio <i>i</i>	Brake torque static Nm	Brake torque dynamic Nm	Appr. weight without motor kg	Compatible hydraulic motors
8150 E	42000	32,3 • 35,4 • 41,4 • 50,6 ¹⁾	²⁾	²⁾	210	A6VE 115 • 160 • 170

Dimensions

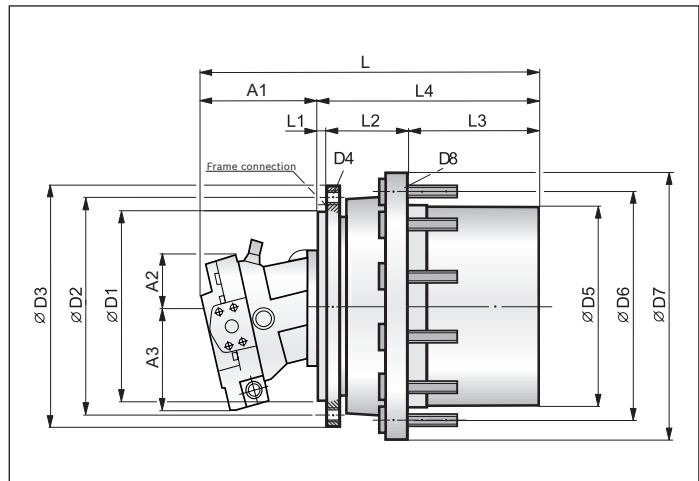

Version W (with wheel studs)

Size GFT	Version	D1	D2	D3	D4	D5	D6	D7	D8	L	L1	L2	L3	L4	A1	A2	A3
8150 E	W	330	370	410	20x M20	365	415	455	12 x ³⁾	¹⁾	12	100	252,5	364,5 ⁴⁾	⁴⁾	⁴⁾	⁴⁾

The values given under „Dimensions“ conform to the standard connecting dimensions. By various motor/gearbox-combinations additional check of the measurements from the motor flange and the gearbox connecting dimensions. Other dimensions on request.

- 1) Depending on motor size
- 2) Device-specific
- 3) 12 x M22 x 1,5 Length = 72 mm
- 4) Depending on motor size and control device

Notes

Overview data sheets Gearbox Technology

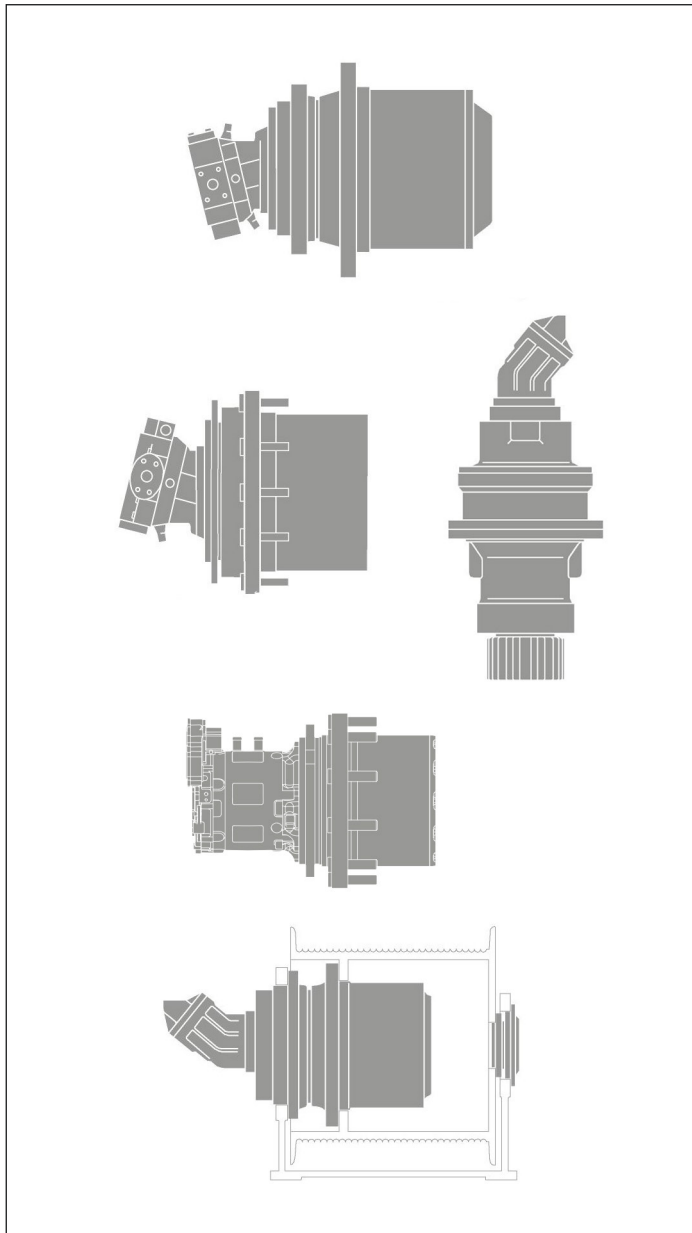

Hydrostatic travel drives

- HYDROTRAC GFT, series 20, RE 77110
Output torques from 160 to 620 kNm
- HYDROTRAC GFT 2160, series 20, RE 77125
Output torques to 42,5 kNm
- HYDROTRAC GFT 8000, series 30, RE 77128
Output torques from 20 to 30 kNm
- HYDROTRAC GFT 8000, series 40, RE 77117
Output torques from 10 to 130 kNm
- HYDROTRAC GFT 8150 with TIS, RE 79093
Output torques to 42 kNm
- HYDROTRAC GFT 45 T2/T3, RE 77115
Output torques max. 45 kNm
- HYDROTRAC GFT 34, series 20, RE 79062
Output torques to 34 kNm

Electromechanical travel drives

- ROTATRAC eGFT 8000, series 40, RE 79082
Output torques from 15 to 42 kNm

Hydrostatic swing drives

- MOBILEX GFB, RE 77201
Output torques from 4 to 68,3 kNm
- MOBILEX GFB 2160, series 20, RE 77208
Output torques to 14,5 kNm
- MOBILEX GFB 8000, series 40, RE 79058
Output torques from 8,5 to 30 kNm

Hydrostatic winch gears

- MOBILEX GFT-W, RE 77502
Output torques from 140 to 325 kNm
- MOBILEX GFW 5000, series 40, RE 77506
Output torques from 7,5 to 105 kNm



Additional information at:
www.boschrexroth.com/gears



GFT 8000 with TIS (Tire Inflation System)
www.youtube.com

Bosch Rexroth AG

Gearbox Technology
Nortkirchenstraße 53
44263 Dortmund
Germany
Phone +49 231 22819-5
info.gears@boschrexroth.de
www.boschrexroth.com

© Bosch Rexroth AG 2019. All rights reserved, also regarding any disposal, exploitation, reproduction, editing, distribution, as well as in the event of applications for industrial property rights. The data specified within only serves to describe the product. No statements concerning a certain condition or suitability for a certain application can be derived from our information. The information given does not release the user from the obligation of own judgment and verification. It must be remembered that our products are subject to a natural process of wear and aging.