

8		7		6			5	4	3	2	1
MODEL NUMBER	CATALOG NUMBER	DISPLACEMENT	OUTPUT FLOW 	A DIM.	B DIM.	C DIM.	INLET PORT (SAE O-RING BOSS)	OUTLET PORT (SAE O-RING BOSS)			
		CM³/REV	LITERS/MIN								
9 510 290 125	AZ-P-F-12-019-RRR12MB	19.6	37.4	110.0	52.4	52.4	1.312-12UN-2B THD.	.875-14UNF-2B THD.			
9 510 290 126	AZ-P-F-12-022-RRR12MB	22.9	44.1	115.4	55.1	55.1					

REV	DESCRIPTION	DATE	BY	CKD
	RELEASE TO PRODUCTION (CRR0319)	10-23-02	GRJ	
A	WAS 87 MAX. (CRR1453)	01-20-06	DN	GRJ
B	ADD OPERATING CONDITIONS (ECN R7878-00055)	04-02-07	MEW	*

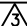
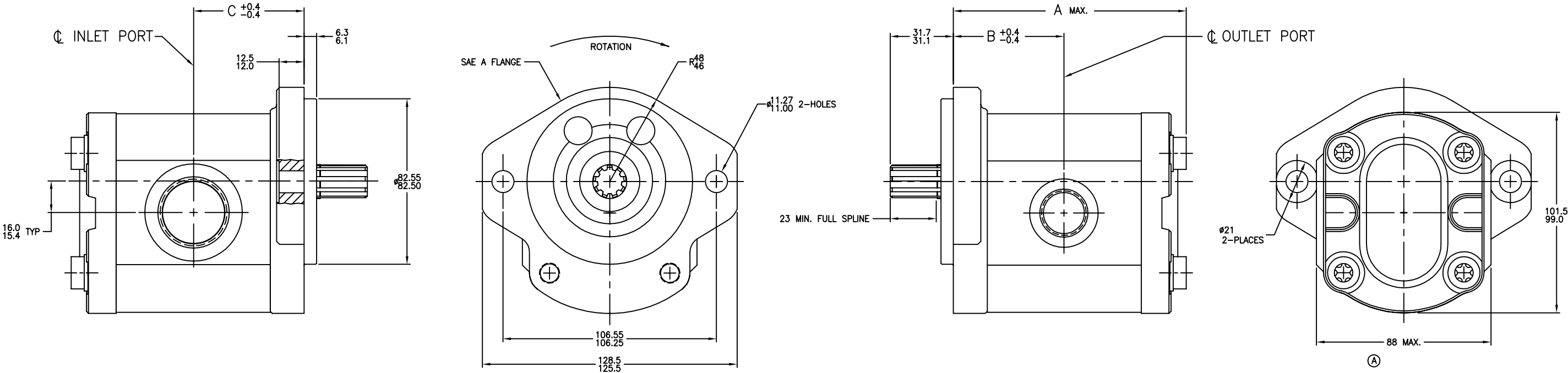

EXTERNAL INVOLUTE SPLINE DATA  
FLAT ROOT SIDE FIT  
FLAT ROOT SIDE FIT  
NO. OF TEETH 9  
SPLINE PITCH 16/32  
PRESSURE ANGLE 30°  
PITCH DIA. .56250 REF.  
MAJOR DIA. .6034-.6085  
FORM DIA. .504  
CIRCULAR TOOTH THICKNESS:  
MAX.EFFECTIVE .0942  
MIN. ACTUAL .0916

GENERAL NOTES:

- METRIC LINEAR MEASUREMENTS ARE IN MILLIMETERS
- ROTATION VIEWING DRIVE END: CLOCKWISE
- OUTPUT FLOWS ARE AT 2000 RPM & 138 BAR USING SAE NO. 10 OIL AT 48°C
- MAX RATED SPEED: UP TO 3500 RPM
- EXTERNAL INVOLUTE SPLINE DATA IN DECIMAL INCHES
- OPERATING CONDITIONS PER Y510 201 598

DO NOT SCALE UNLESS OTHERWISE SPECIFIED: TOLERANCES PER DIN 7180mm		DIN GRJ	DATE 10-23-02	DESCRIPTION	SCALE FULL
LINEAR DIMENSION TOL. 0- 6- ±0.1 6- 30- ±0.2 30- 120- ±0.3 120- 400- ±0.5 400-1000- ±0.8 ANGLES ± 1°		APP'D	DATE	TITLE PUMP-GEAR, INSTALLATION	SHEET 1 OF 1
METRIC		REV. B	INTERIM	CAD-ORIGINAL Revisions thru CAD only	<b>Rexroth Bosch Group</b> FOUNTAIN INN, SC 29644
THIRD ANGLE PROJECTION		ALL PROPRIETARY RIGHTS IN THE SUBJECT MATTER HEREOF ARE RESERVED, AND NO PERMISSION IS GRANTED TO REPRODUCE THIS PRINT IN WHOLE OR PART, OR TO DISCLOSE ANY OF THE INFORMATION UPON IT TO OTHERS.			