

8		7		6		5		
MODEL NUMBER	CATALOG NUMBER	DISPLACEMENT	Ⓔ	MAX CONTINUOUS PRESSURE	MAX ROTATIONAL SPEED	A DIM.	B DIM.	C DIM.
		CM <sup>3</sup> /REV		BAR	RPM			
9 511 290 013	AZ-M-F-12-008-UQR12ML-S0022	8.2		210	4000	91.6	43.2	85.8
9 511 290 014	AZ-M-F-12-011-UQR12ML-S0022	11.3		210	3500	96.6	45.7	90.8
9 511 290 015	AZ-M-F-12-014-UQR12ML-S0022	14.4		210	3000	101.6	48.2	95.8
9 511 290 016	AZ-M-F-12-016-UQR12ML-S0022	16.5		210	3000	105.0	49.9	99.2
9 511 290 017	AZ-M-F-12-019-UQR12ML-S0022	19.6		180	3000	110.0	52.4	104.2
9 511 290 018	AZ-M-F-12-022-UQR12ML-S0022	22.9		170 Ⓔ	3000	115.4	55.1	109.6

REV	DESCRIPTION	DATE	BY	CKD
	RELEASE TO PRODUCTION (CRR0449)	04-22-03	D.N.	GRJ
A	1.) ADDED DRAIN LINE PRESSURE NOTE (CRR0911)	05-28-04	JPC	D.N.
A	2.) "INPUT" FLOW WAS "OUTPUT", NOTE 3 (CRR0911)	05-28-04	JPC	D.N.
B	CHANGED TO WOODRUFF KEY (CRR1193)	02-17-05	GRJ	GTW
C	CHANGED TO STRAIGHT KEY (CRR1476)	01-16-06	GRJ	
D	WAS 87 MAX (CRR1453)	01-23-06	DN	GRJ
E	CHANGED PER ECN (ECN R7878-00206)	03-11-08	MEW	*

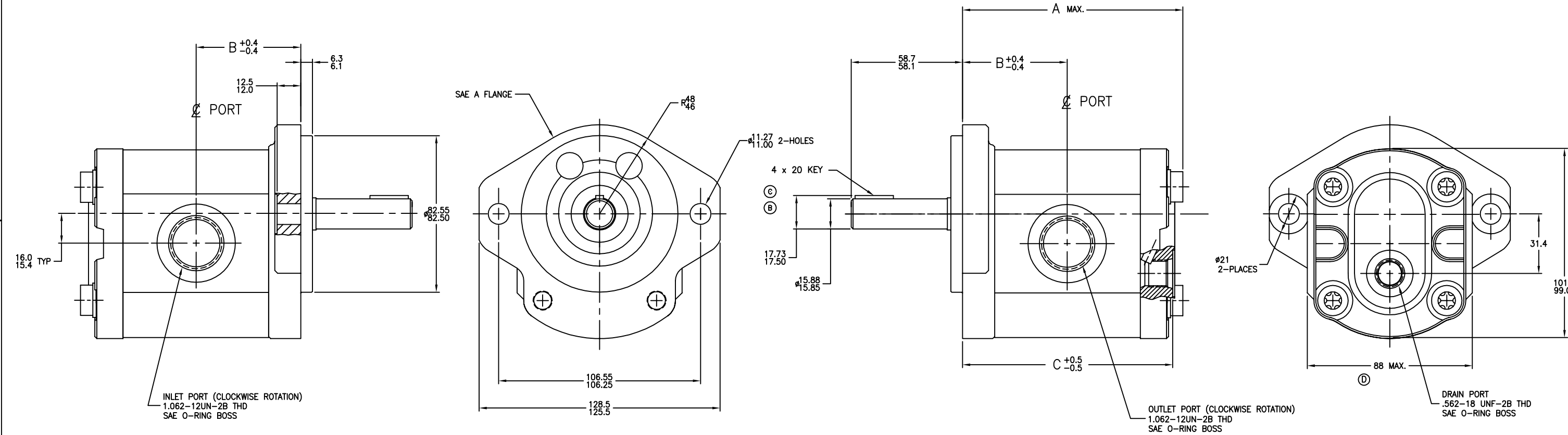

GENERAL NOTES:

- METRIC LINEAR MEASUREMENTS ARE IN MILLIMETERS
- ROTATION : BI-ROTATIONAL
- Ⓔ Ⓔ Ⓔ
- INLET AND OUTLET PORTS CALL-OUT SHOWN FOR CLOCKWISE ROTATION. INLET AND OUTLET WOULD BE REVERSED FOR COUNTERCLOCKWISE ROTATION.
- Ⓔ DRAIN LINE PRESSURE NOT TO EXCEED 3 BAR.

DO NOT SCALE UNLESS OTHERWISE SPECIFIED TOLERANCES PER DIN 7180mm		DIN D.N.	03-27-03	DATE	DESCRIPTION	SCALE	FULL
LINER DIMENSION TOL. 0- 6= ±0.1 6- 30= ±0.2 30- 120= ±0.3 120- 400= ±0.5 400-1000= ±0.8 ANGLES = ± 1°		GRJ	04-25-03	DATE	TITLE	SHEET	1
METRIC		APPD		DATE		OF	1
THIRD ANGLE PROJECTION		REF.	9510 290 133	REV.	E	INTERNAL	
ALL PROPRIETARY RIGHTS IN THE SUBJECT MATTER HEREOF ARE RESERVED, AND NO PERMISSION IS GRANTED TO REPRODUCE THIS PRINT IN WHOLE OR PART, OR TO DISCLOSE ANY OF THE INFORMATION UPON IT TO OTHERS.		Revisions thru CAD Only		Rexroth Bosch Group WOOSTER, OHIO 44691			